

NOTES:

- MAT'L: POLYETHYLENE FOAM, 4.0 PCF, COLOR: BLACK.
- ASSEMBLE CUSHION USING HOT MELT ADHESIVE OR ENGINEERING APPROVED EQUIVALENT.

ECO	REV	DESCRIPTION	BY/DATE
5-17133	A	INITIAL RELEASE	FSG 16MAR02

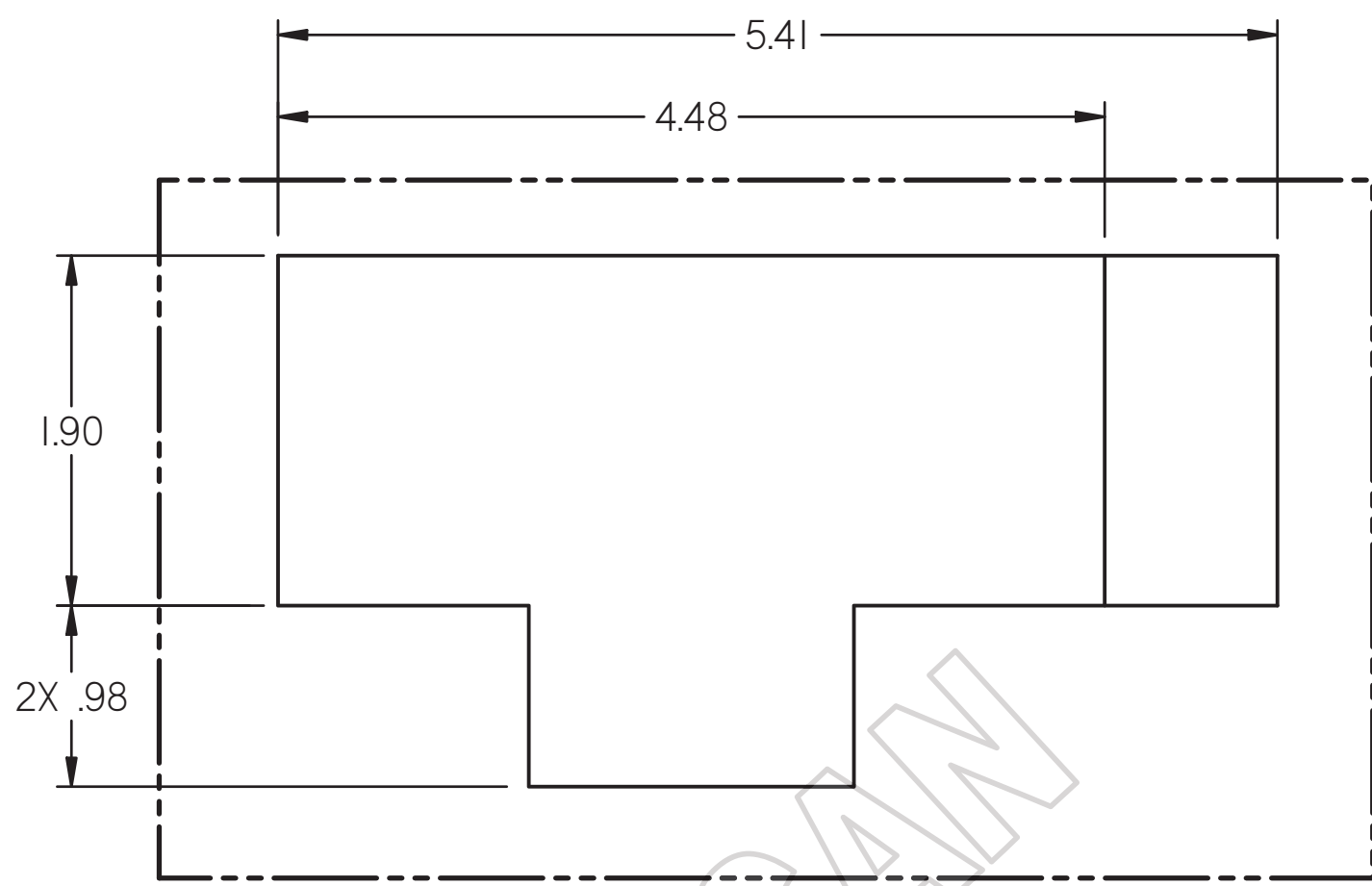
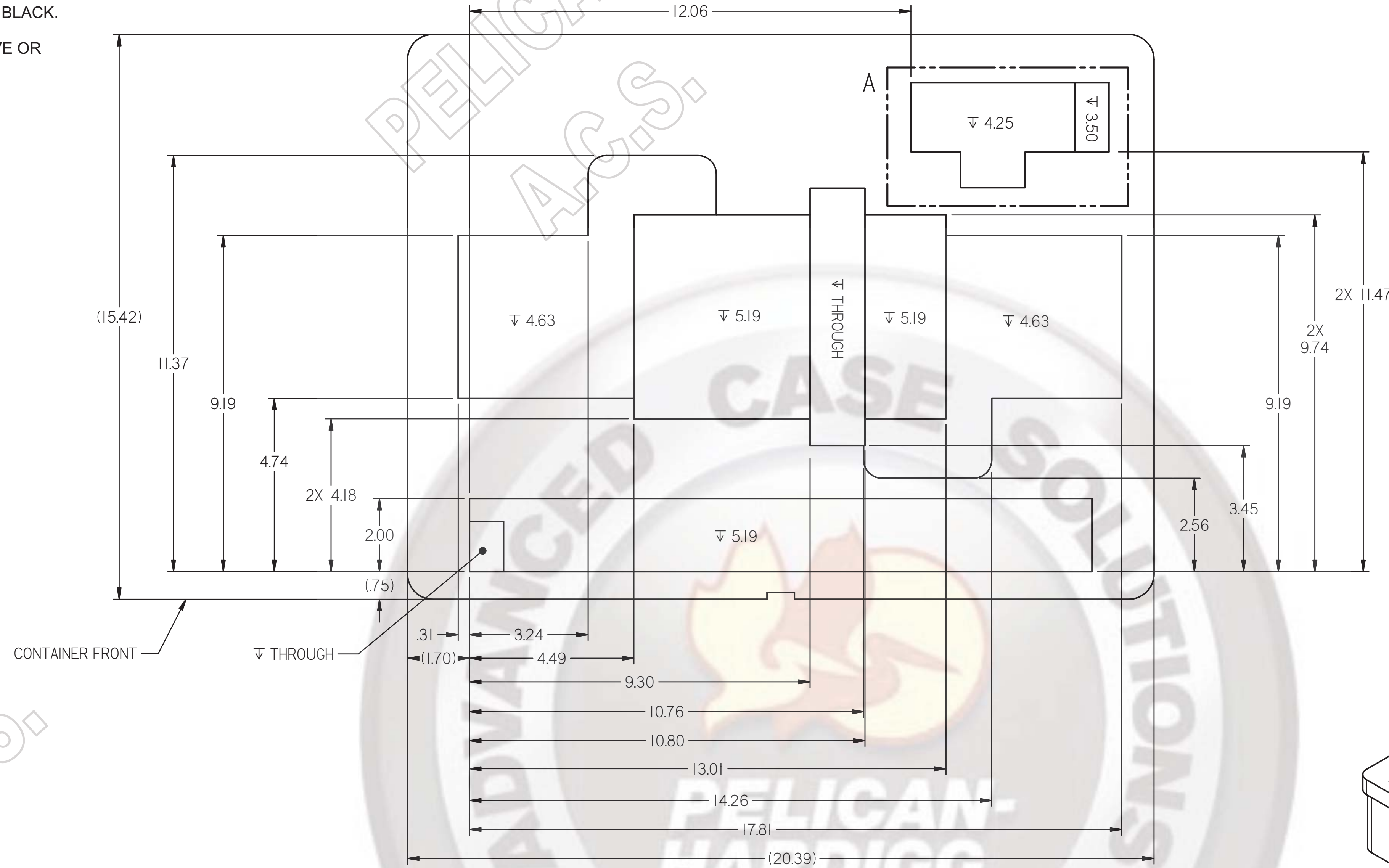

DETAIL A

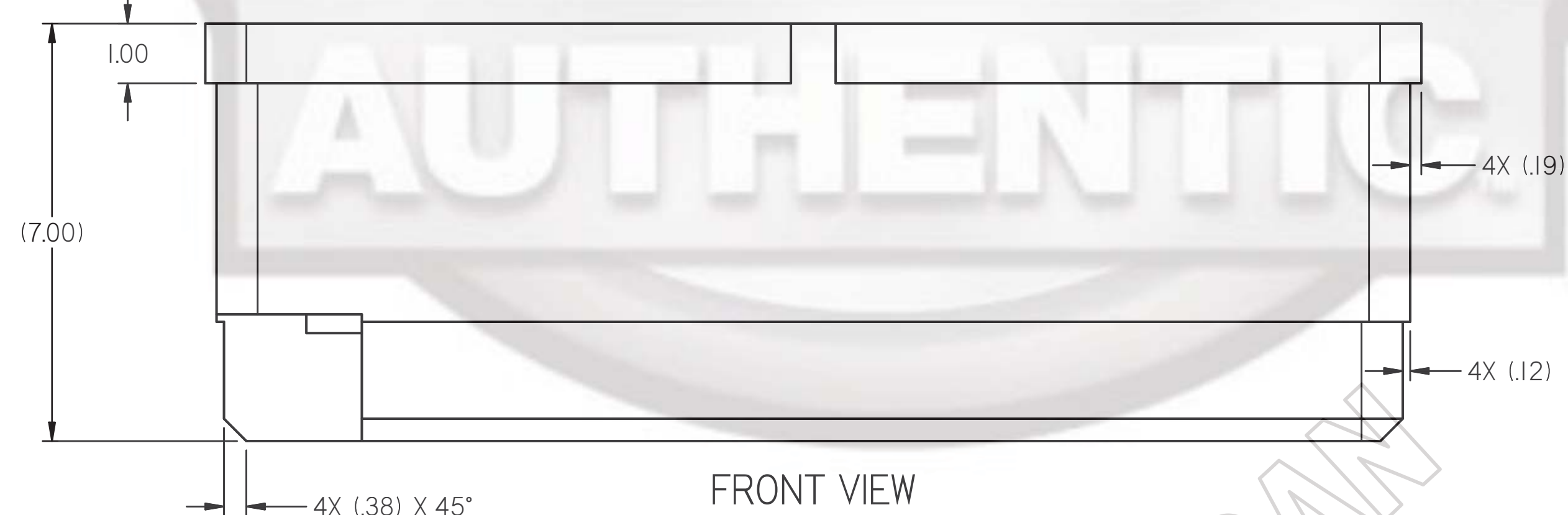

FRONT VIEW

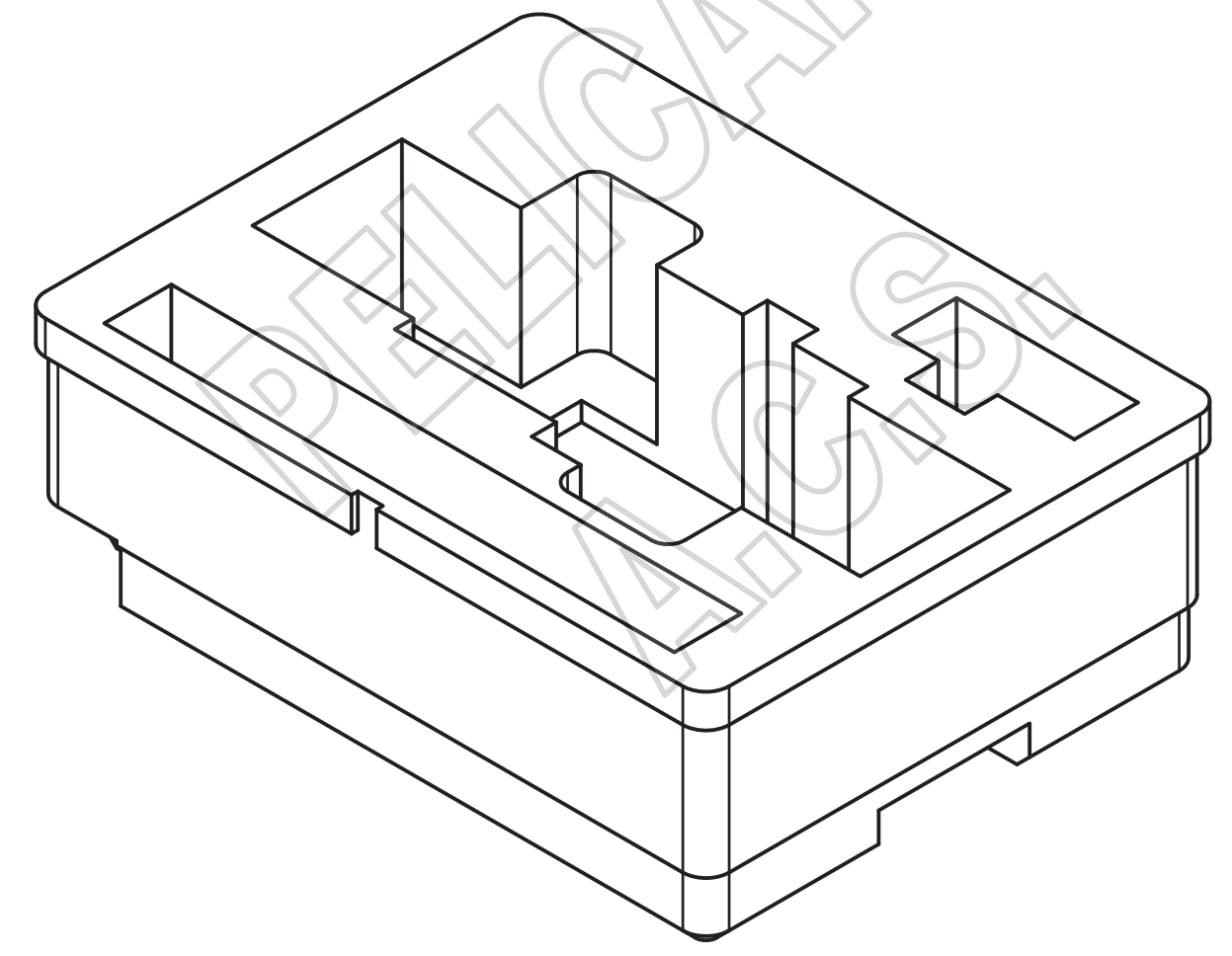

1:4

TOLERANCE FOR POLYETHYLENE FOAM CUSHIONS	
CAVITY DIM. UP TO 6"	-.09 -.06
CAVITY DIM. OVER 6" TO 18"	-.12 -.09
CAVITY DIM. OVER 18" TO 36"	-.25 -.09
CAVITY DIM. OVER 36"	-.31 -.09
LOCATION OF CUTOUTS	-.12 -.12
OUTSIDE DIM. UP TO 18"	-.09 -.19
OUTSIDE DIM. 18" TO 36"	-.12 -.25
OUTSIDE DIM. OVER 36"	-.19 -.31
ALL ANGLES	.5° -.5°
ALL OTHER DIMS.	-.12 -.12

COMPUTER GRAPHICS DRAWING  
 CHANGES TO THIS DRAWING MUST BE INCORPORATED VIA THE COMPUTER GRAPHICS SYSTEM.

This drawing and all copies and the design and data shown are the property of HARDIGG INDUSTRIES, INC. So. Deerfield, MA U.S.A. and include proprietary information. The borrower by receipt or retention of the drawing agrees that, except as expressly authorized in writing by HARDIGG INDUSTRIES, INC. it will (1) not use the drawing or any copy of the design or data shown (2) not reproduce, copy, except, exhibit or distribute the drawing or any copy for use by others and (3) upon demand return the drawing, all copies and all material copies therefrom.

TOLERANCE UNLESS OTHERWISE SPECIFIED	.XX	.XXX	ANGLE
	±	±	± °
DESIGNED BY/DATE:	FRANK GONZALEZ		2016/03/02
APPROVED BY/DATE:	FRANK GONZALEZ		2016-Mar-02
CUSTOMER:	INTERFACE INC		
UNIT:	CX-0220, CABLE, 815113A		
CNTR SIZE:	PELICAN 1560		
DWG REF:	REF REV:		
CONFIG CHANGE			
PREVIOUS DWG REF:			

**HARDIGG® CASE CENTER**  
 Ontario, CA 91764  
 A Division of Hardigg® Industries Inc.  
 South Deerfield, Massachusetts 01373 USA

**BASE CUSHION DETAILS**

SIZE	CAGE CODE	DWG NO	REV
<b>D 4UDR8</b>		<b>023187-01</b>	<b>A</b>
SCALE	1/2	CASE CENTER NO: 001	SHEET 1 OF 1